

FESTOOL

Perfection in XXL.

TS 75, the powerful and handy plunge-cut saw with 75 mm cutting depth.



The TS 75 plunge-cut saw

All benefits at a glance

Up to 75 mm cutting depth without

Cutting tough, thick Australian hardwoods? That's where the TS 75, with its 75 mm cutting depth and full-wave electronics, really stands out from the crowd. Ripping down slabs of blue gum? The TS 75 is your solution - a unique combination of impressive power and unmatched precision.

Together with the guide rail, the TS 75 allows for flexible work. Of course, it does this with the typical Festool advantages for better, easier and faster results.

Easy-to-reach return stop.

The return stop prevents kick-back when plunged into the material. It is always within reach in the practical depot and allows for safe work.



Rotating extractor connector.

More freedom of movement, less wear. The extractor hose never gets tangled, does not get in the way and is, therefore, always where it should be - this is good for your safety.



Sliding clutch.

If the saw blade gets jammed, the sliding clutch prevents kick-back.



Spring-loaded riving knife.

It is always there when you need it. The spring-loaded riving knife retracts into the housing automatically when the saw is plunged into the material.



Electronically controlled.

The MMC electronics can be used to effortlessly adapt the speed to suit the material. And the speed remains constant - even when plunge-cutting. The saw blade is stopped in 2 seconds thanks to the quick-acting safety brake system.



plug it connection and Softgrip

Up to 75 mm cutting depth



comparison.



FastFix saw blade changing system.

Change blades quickly, so it's easy to match the blade to the material you're cutting.



Triple bearing.

The triple bearing of the motor improves the running smoothness and extends the service life.



Zero-play guidance.

The guidance jaws on the guide rail can be set using just two fingers. This allows for zero-play guidance of the machine, which in turn increases the cutting quality.



Exact depth setting.

The notched depth stop makes it possible: cutting depth setting accurate to the millimetre.

Splinterguard on both sides.

Splinter-free sawing on both sides. The clip-on splinterguard and the guide rail make it possible.

A wide range of possibilities.

To ensure that every cut is made successfully, Festool offers a wide range of saw blades with a diameter of 210 mm. Every saw blade model is tailored to a specific range of applications. When used accordingly, it guarantees an optimum work result. This saves time and money. In addition, thanks to the FastFix saw blade changing system, every saw blade is changed in no time at all.



Panther circular saw blade

For rapid sawing with low application of power, especially in the case of rip cuts in solid wood. Suitable for hard and soft woods.



18-tooth circular saw blade

A sturdy blade for all building panels, soft plastics and wood.



Universal circular saw blade

An all-rounder for working on all woods and wooden materials as well as building panels, plasterboard and soft plastics.



Fine-tooth circular saw blade

A fine-cut blade for clean cross-cuts free of splinters in solid wood, and for laminated or veneered board materials.



Special circular saw blade for laminate

With a special fine-grain carbide, this blade is ideal for laminated boards and mineral materials, giving a much longer service life.



Special circular saw blade for aluminium

Ideal for aluminium panels and profiles as well as for hard and fibre-reinforced plastics.



Flat-tooth circular saw blade

Thanks to its slightly chamfered teeth, this saw blade is ideal for sawing steel cable ducts, steel plate and steel profiles.

Ordering information can be found on Page 7.

The TS 75 plunge-cut saw

Powerful in action.

Something special and not only because

Quick and precise



With one cut through thick and thin.

The cutting depth of 75 mm and the power of 1600 Watts are ideal for jobs involving larger workpieces. They also enable you to saw thick workpieces with one cut. No more time-consuming work from two sides. This minimises reworking and saves you having to go to the trouble of turning the workpiece.

Always work at accurate angles.

With the TS 75, accurate cutting of angles is a matter of course

Here, the scribe line is always the same as the cutting edge, even when cutting bevels. And this can be set accurately from 0° to 47° on the easy-to-read scale.



Angled cuts can be set and read precisely with the cutting indicator.



The scribe line is the same as the cutting edge, even when performing angled cuts.

Flexible



A principle of flexibility.

Where 65 mm machines reach their limits is where the TS 75 really comes into its own – and it has a handy shape. The unbeatable plunge-cutting principle and the appropriate saw blade also enable you to easily master trimming work in virtually all materials up to 75 mm thick (eg sandwich boards or cable ducts).

Why struggle when it can also be done using FastFix?.

Various materials are often sawn with one saw blade. Of course, this is often at the expense of quality. But Festool has the solution: the FastFix saw blade changing system. This is how easy it is, without awkward handling.



① Open the FastFix lever, press the machine down as if you are plunge-cutting until you hear it engage. The spindle stop is activated.



② Now your hands are free. Simply open the bolt using the Allen key and remove the saw blade.



③ Insert the new blade, tighten the bolt, close the FastFix lever and move the machine upwards. Done.



④ Conclusion: This is how you gear your work towards the material: with the right saw blade.

ause of its size.

Safe



The spring makes the difference

When plunge-cutting, a fixed-position riving knife gets in the way. Not on the TS 75. Its riving knife is spring-loaded and retracts into the housing automatically when the saw is put onto the workpiece. As the tool is plunged, the riving knife slides into the cut, preventing the blade from jamming. This means that the riving knife is always on the saw, ensuring permanent safety.

Safe and accurate plunge-cutting.

The return stop on the TS 75 performs two tasks at once: when fitted onto the guide rail, it prevents kick-back during plunge-cutting and it holds it in the set position. This ensures pinpoint accuracy when plunge-cutting.



Simply pull the return stop out of the depot and put it onto the guide rail.



Retracted riving knife for plunge-cutting.

Lowered riving knife for sawing.

The faster way to a clean cut – with the guide rail system from Festool.

Modern portable circular saws have to meet many requirements. They have to be mobile and versatile but still have to work virtually as precisely as bench-mounted tools. Festool makes this possible.

The famous plunge cut saws from Festool fit perfectly on the guide rail. The result: cuts that are as straight as they are splinter-free – due to the patented splinterguard on both sides.

The TS 55 and TS 75 plunge-cut saws are true examples of versatility and mobility. They have many features such as FastFix saw blade changing system, spring-loaded riving knife or the intelligent MMC electronics.

By the way, if you are impressed with the individual tool, you will be amazed when you see it as part of a system. Whether it be the combi-bevel, stop adapter or effortless connection to the dust extraction, everything fits and optimises your work.

This is what makes Festool plunge-cut saws different:

- Precise sawing along the scribe line using the rail
- Splinter-free cuts
- Long service life and sturdy design
- FastFix saw blade changing system (TS 55 and TS 75)
- Versatile operation with guide rail and multifunction table
- Wide range of circular saw blades.

Sawing on rails.

No one develops tool systems like Festool, where the focus is always providing ideal solutions to daily tasks. This is why we invented the guide rail over 40 years ago and are constantly setting new standards with our plunge-cut saws. Together they are representative of a strength that makes Festool so unique: thinking in a system.



The TS 75 plunge-cut saw

Specifications, accessories and consumables.

The TS 75 plunge-cut saw

Large saw with depth



Applications

- Precise plunge cuts in materials with a thickness of up to 75 mm
- Doors cut to size perfectly – guide rails with plunge cut saws
- Cutting a variety of framing materials
- Cut cable conduit to size, quickly and cleanly
- Cutting raised flooring in one pass
- Cutting thick composite material panels

Features

- FastFix for quick and easy saw blade changes - use the right blade for the job
- Spring-loaded riving knife for unimpeded plunge cuts
- Attachable splinterguard for high quality results
- Fast acting brake for safe and comfortable work
- Clearance adjustment on the guide rail without the use of tools

Technical data	
Wattage	1,600 W
Cutting depth 45°/90°	0-55/0-75 mm
No-load speed	1,350-3,550 rpm ⁻¹
Saw blade diameter	210 mm
Bevel cut range	0°-47° Adjustable fixed stop at 45°
Connection diameter for dust extraction	27/36 mm
Weight	6.2 kg
All versions of the TS 75 are equipped with electronics.	



The plunge-cut saw family.

You know best what the emphasis of your work is. Here you can see which features on the smaller TS 55 and the larger TS 75 best suit your work.

Both saws lead quickly and safely to a precise cut because the saw blade plunges accurately from above. And both saws work in the proven Festool System. At a glance:

	TS 55	TS 75
FastFix saw blade changing system	X	X
Spring-loaded riving knife	X	X
Return stop in depot		X
Clip-on splinterguard	X	X
Tool-free play setting for guide rail	X	X
MMC electronics	X	X
SSB quick-acting safety brake system	X	X
Sliding clutch		X
Exact depth setting	X	X
Angled cuts 0°-45°	X	X
Angled cuts 0°-47°		X
Adjustable fixed stop at 45°	X	X
Softgrip	X	X
plug it-cable	X	X
Rotating extractor connector	X	X
Weight	4.5 kg	6.2 kg
Cutting depth	55 mm	75 mm
Power consumption (electronics)	1200 W	1600 W

TS 55

Simply perfect.



TS 75

Perfection in XXL.



TS 75 plunge-cut saw – Model versions

Scope of delivery: carbide-tipped universal saw blade W 36, return stop and operating tool.

Model	Equipment/Scope of delivery	Order no.
TS 75 EBQ-Plus	With splinterguard, in a SYS 5 Systainer	561 191
TS 75 EBQ-Plus-FS	With splinterguard, guide rail FS 1400/2, in a SYS 5 Systainer	561 183

TS 75 – System accessories and consumables

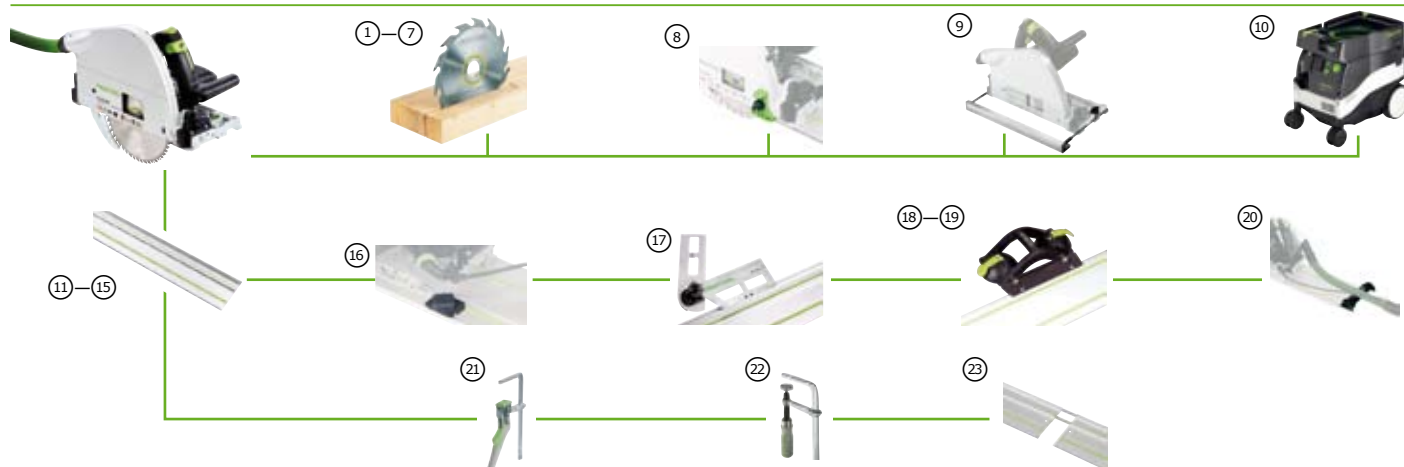

TS 75 – System accessories

Produkt	Erläuterung	Order no.
① Panther saw blade ¹⁾	Dimensions in mm: 210 x 30; Number of teeth: 16; Tooth shape: PW; Cutting width in mm: 2.6	493 196
② 18-tooth saw blade ¹⁾	Dimensions in mm: 210 x 30; Number of teeth: 18; Tooth shape: W; Cutting width in mm: 2.6	493 197
③ Universal saw blade ^{1) 2)}	Dimensions in mm: 210 x 30; Number of teeth: 36; Tooth shape: W; Cutting width in mm: 2.4	493 198
④ Fine-tooth saw blade ¹⁾	Dimensions in mm: 210 x 30; Number of teeth: 52; Tooth shape: W; Cutting width in mm: 2.4	493 199
⑤ Special saw blade for laminate ¹⁾	Dimensions in mm: 210 x 30; Number of teeth: 60; Tooth shape: TF; Cutting width in mm: 2.4	493 200
⑥ Special saw blade for aluminium ¹⁾	Dimensions in mm: 210 x 30; Number of teeth: 72; Tooth shape: TF; Cutting width in mm: 2.4	493 201
⑦ Flat-tooth saw blade ¹⁾	Dimensions in mm: 210 x 30; Number of teeth: 36; Tooth shape: F; Cutting width in mm: 2.2	493 351
⑧ Splinterguard SP-TS 55/75	For splinter-free cuts on both sides. Qty. in pack: 5	491 473
⑨ Parallel stop PA-TS 75	Can be used as parallel stop and table widener.	492 243
⑩ Mobile dust extractor CTM 22 E SG3 ³⁾	Tested as per EN 60335/IEC 335 standard with dust category M approval.	583 458
⑪ Guide rail FS 1400/2	Length: 1400 mm	491 498
⑫ Guide rail FS 1900/2	Length: 1900 mm	491 503
⑬ Guide rail FS 2400/2	Length: 2400 mm	491 502
⑭ Guide rail FS 3000/2	Length: 3000 mm	491 501
⑮ Guide rail FS 5000/2	Length: 5000 mm	491 500
⑯ Return stop FS-RSP	Is inserted into the 2nd groove on the guide rail, prevents kick-back.	491 582
⑰ Combi-bevel FS-KS	For mounting in the 2nd groove on the guide rail, makes precise angled cuts between 0° and 180° possible.	491 588
⑱ Double suction lifter GECKO DOSH	Double suction lifter with two suction cups for carrying boards or securing the guide rail with adapter.	492 617
⑲ Adapter GECKO DOSH-FSAD	Used in conjunction with the double suction lifter for securing the guide rail to the workpiece	492 616
⑳ Guide-rail deflector FS-AW	Prevents the suction hose and the cable getting tangled on the end of the guide rail. Qty. in pack: 1	489 022
㉑ Lever clamp FS-HZ 160	Quick and easy clamping; Fitting width: 160 mm. Qty. in pack: 1	491 594
㉒ ClampsFSZ 120	Polished steel version; Fitting width: 120 mm. Qty. in pack: 1	489 570
㉓ Guide-rail connector FSV	For connecting two guide rails for long workpieces. Qty. in pack: 1	482 107

¹⁾ For an application description, see Page 3 ²⁾ ncluded in the scope of delivery

³⁾ For other models, take a look at our main catalogue, contact your specialist dealer or visit www.festool.com.au

- News and promotions
- Online product catalogue
- Online shops
- Dealer search
- Test reports
- Service
- Application examples
- 3D animation

Your link to more information

On our Festool website you can find information about

- new products
- helpful application examples
- our comprehensive after-sales service
- the complete product range
- product features in detail
- And all of this at your leisure

And all of this at your leisure.

Order around the clock from your Festool System Partner Dealer.

It's easy: just visit www.festool.com.au

FESTOOL

www.festool.com.au

Tooltechnic Systems (AUST) Pty Ltd

Postal address: PO Box 4401
Dandenong South VIC 3164

Phone: 1800 063 900
Fax: 03 9799 9766
Service Hotline: 1800 063 900
E-mail: sales@festool.com.au

www.festool.co.nz

Tooltechnic Systems (NZ) Ltd

Postal address: PO Box 258-078
Greenmount 2141, Auckland

Phone: (09) 272 2220
Fax: (09) 272 2230
E-mail: sales@tooltechnic.co.nz

Three years guarantee – that means three years security.



Festool grants a 1 year guarantee from the date of purchase, as long as the tool has been used correctly. This guarantee is automatically extended by a further two years, provided that the warranty form with every new tool is completed correctly and returned to Festool Australia within 30 days of the date of purchase.

Make a contribution yourself – support the WWF together with Festool!

Our most important contribution to preserving our environment



is the quality of our products, which are characterised by their durability and positive eco-features such as recyclability and environmental compatibility.

By purchasing one of the promotional products, you are supporting our collaboration with the WWF and will receive a WWF panda keyring as a thank-you gift..

© 1986 Panda symbol WWF – World Wide Fund For Nature (Formerly World Wildlife Fund)
® „WWF“ and „living planet“ are WWF Registered Trademarks

www.festool.com/wwf

Dealer