

Simply a cut above the rest

The sawing system for construction

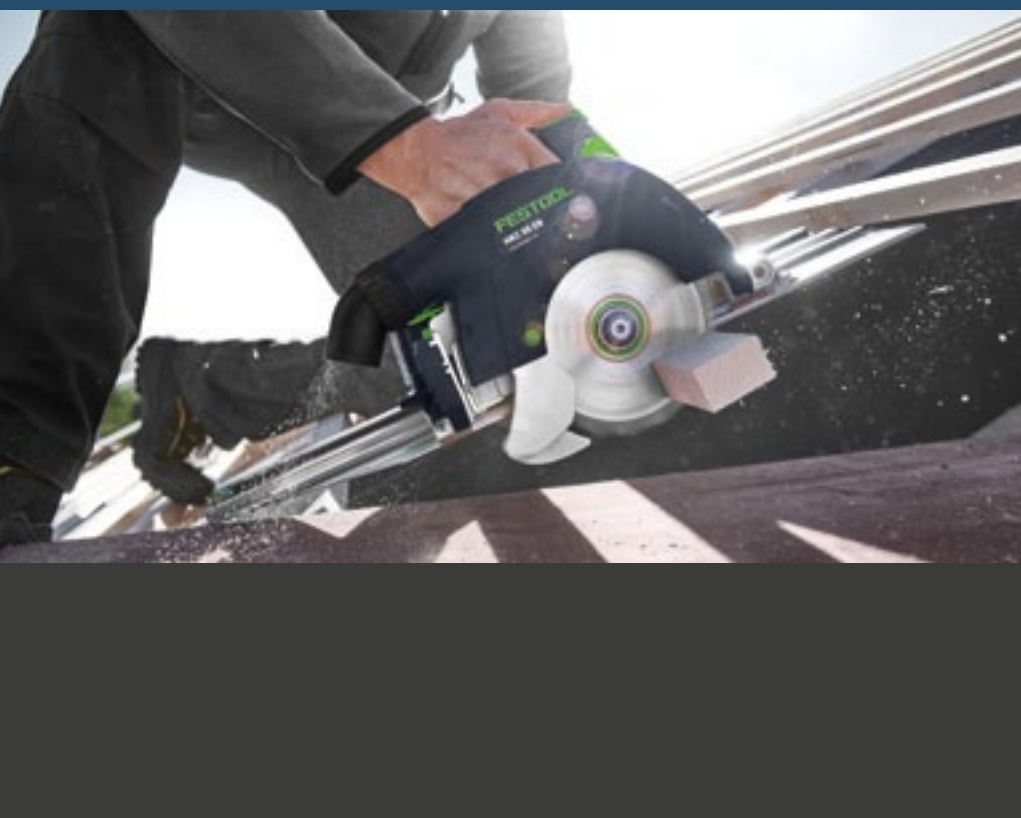

FESTOOL
Tools for the toughest demands

Sawing is our tradition. And our future.

In 1931 we only had one saw. But even that pendulum cover saw had all the qualities which still set our entire range apart from the rest. And it set new standards in construction. Just like the development of the guide rail or the triple saw blade guide for pendulum jigsaws, for example.

Today Festool provides the ideal solution for practically every construction job. And no matter whether circular saw, pendulum jigsaw, plunge saw or trim saw – they all fulfil the challenges which have to be conquered every day on the building site from framing stage to lock up, fix and finishing, to building facades, stairways as well as in the workshop.

Robust, powerful, efficient – and with no sockets or cables if so desired. For example the new HKC 55 cordless circular saw, the TSC 55 cordless circular saw and the PSC 420 cordless pendulum jigsaw, which give you maximum independence in construction.

But whether it's cordless you need or not, all saws bearing the Festool name carry on the tradition of our first pendulum cover saw. For example the three new circular saws HKC 55, HK 55 and HK 85. With their unique robustness and reliability. With their ease of use and high functionality. And with their unparalleled precision and efficiency. Since 1931.

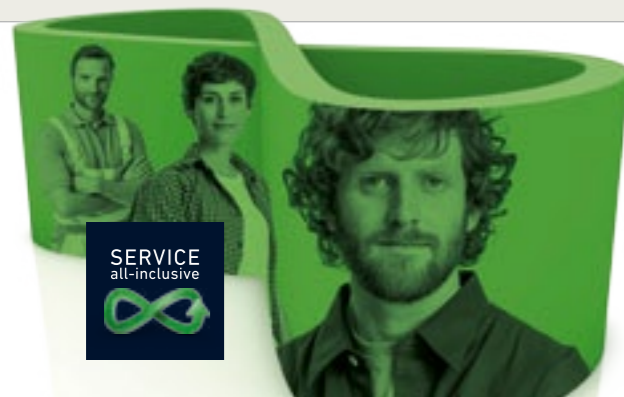

Not only high-quality tools are a tradition for us. Good service is too.

Peace of mind!

Register and enjoy all the advantages of SERVICE all-inclusive. More information on pages 14 and 15.

HKC 55 | HK 55 | HK 85

The new HK/HKC – not just a saw. But a uniquely versatile all-rounder.

The HKC 55 cordless circular saw and the HK 55 and HK 85 circular saws in combination with the FSK cutting rail. The new circular saw system for more independence combines versatility and efficiency with a high level of user-friendliness, optimised ergonomics and ease of use.

Features such as the cutting depth adjustment with plunge cut function, the hinged-cover remote control, guide wedge and FastFix saw blade change, for example, provide the best possible working conditions. And the FSK cutting rail provides precise cutting with repeat accuracy.



Extremely easy depth adjustment: Simply push the lever and set the desired cutting depth using the clearly visible and easy-to-read scale, then release – and you're done. Combine this with the plunge cut function and you will find you can make plunge cuts to the preset cutting depth easily and conveniently.



Hinged-cover remote control: To enable a clear view of the saw blade, the hinged protective cover can be moved backwards from the front handle, thus uncovering the saw blade. And your hands always remain at a safe distance from the saw blade.



Guide wedge for a high level of safety: The guide wedge enables unobstructed, stress-free and therefore safe sawing. Because it is integrated into the spring-mounted hinged cover, it is also possible to carry out plunge cuts in a safe and unobstructed way.



Viewing window and cutting indicator: The open construction and the viewing window on the inside provide a good view of the scribe mark and saw blade. The continuous cutting indicator also increases precision.



Unique: HK 85 including groove router. Turn your new HK 85 circular saw into a powerful groove router in an instant – with just a few steps and the conversion kit for adjustable routing, which is available separately. Ideal for longitudinal and transverse grooves, rafters and inserted ceilings.



The quick-acting closure: The three new circular saws can be coupled to the cutting rail or decoupled from it in an instant. Depending on whether you want to saw with or without a guide. One system for all three new circular saws.



The stop system: The fixed positioning bolt and the adjustable stop allow angle cuts from -60° to $+60^\circ$ to be made and repeated exactly. For simple work, lock the most common angle settings into place in the rail.



The retraction function: To ensure it is always ready for use, the cutting rail has an adjustable stop and an integrated rubber spring, which automatically brings the HK/HKC back to the starting position.



The new generation of circular saws. Built for construction work.



For us, service means always being there when you need us. No matter what happens.

Including 36 month warranty.

Register and enjoy all the advantages of SERVICE all-inclusive.

More information on pages 14 and 15.



For more mobility in construction: the HKC 55 cordless circular saw with FSK cutting rail demonstrates what a modern saw can achieve on the roof.

One click and you're done. Coupling the HKC 55, HK 55 and HK 85 with the FSK cutting rail, which is available in three lengths, is incredibly easy.



Whether on the roof or on firm ground, whether reproducible angle cuts and guided cuts in combination with the FSK cutting rail and the FS guide rail or precise mitre cutting – the HKC 55 cordless circular saw and the HK 55 and HK 85 circular saws demonstrate what modern circular saws are capable of. And they prove it time and again in every cut. With their versatility, flexible usability and maximum precision. Day after day.

Precision guidance: The new circular saws demonstrate their versatility when combined with the Festool guide rail system, too.

From circular saw to groove router: With the conversion kit for adjustable routing, the versatile HK 85 is transformed into a groove router for transverse and longitudinal grooves.

Scribe mark = cut. When sawing in combination with the guide or cutting rail, the cutting edge will always follow the scribe mark edge exactly, even when mitre cutting.



HKC 55 cordless circular saw



HK 55 circular saw



HK 85 circular saw

More hand-guided saws.
It's all under control.



Ideal for mobile use: The UNIVERS sword saw weighs only 6.5 kg with a cutting depth of 200 mm and can also be combined with the guide rail. Ideal for cutting wood and pressure-resistant insulating materials.



Saw blade off, bird's mouth bit on: The HK 132 E circular saw can be turned into a reliable bird's mouth router with little effort using the bird's mouth attachment.



Even more precise when out and about. The TS 55 R circular saw for easy and precise plunge cuts on a material thickness of up to 55 mm.



For unbeatable power on the straights; it's like cutting through butter on bends: The PSC 420 cordless pendulum jigsaw with 3,800 strokes per minute.

And from a single source. Notches, curves, bird's mouths, longitudinal cuts or through thick and thin material. With Festool hand-guided saws you're ready to take on any construction job. A cut above the rest with powerful, efficient and precise performance.



CARVEX PSC 420 cordless pendulum jigsaw



Circular saw TS 55 R



HK 132 E carpentry circular saw



UNIVERS SSU 200 sword saw

Semi-stationary sawing.

Mobile or stationary? Both!



Extreme precision for the perfect cut. You'll be impressed by the KS 120 and its precise cuts, thanks to its double-column guide, powerful cutting capacity of up to 120 mm and light weight of 21.5 kg.



Versatility made easy. The CS 70 is quick to set up thanks to its integrated foldaway legs. And conversion from rip cuts to cross cuts is also quick with the all-round V-groove for applying the angle stop.



First class in every detail. A double laser line precisely marks the saw cut.



Powerful through wood. The CS 70 always shows its true qualities when workpieces with a material thickness of up to 70 mm need to be powerfully sawn.

Not done by half. With the KAPEX KS 120 sliding compound mitre saw and the PRECISIO CS 70 trimming saw, precision and versatility are always close at hand in construction. Both in the workshop and on site.



KAPEX KS 120 sliding compound mitre saw



PRECISIO CS 70 trimming saw

The Festool 18-volt system. More independence in construction.

Endurance and precision. With absolute ease. The Festool 18-volt system frees you from the constraints of electrical sockets and guarantees the best results every time. With the combination of a 5.2 Ah high-performance battery pack and brushless EC-TEC motor.

For tools that set the pace when it comes to performance, speed and impact energy. That complement each other perfectly in terms of dynamics, convenience and efficiency, creating a better rhythm for your work. And that includes everything you need to be inspired every day anew with SERVICE all-inclusive.

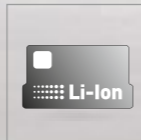

➔ For more information, go to www.festool.com.au

POWERSELECT

Simply select. Simply combine. Simply brilliant.

With PowerSelect, all doors are open to you: starter sets for a perfect way to get started, basic variants as a logical extension to the system, and accessory battery packs and chargers available to buy later. In short: you only buy what you really need.

>>> For more information, go to www.festool.com.au

BASIC

Basic device in a SYSTAINER

Purchase a basic device and use existing battery packs. The perfect addition to your Festool system.



ENERGY

5.2Ah battery pack and charger available separately

Buy later without the 'buy-later' trap. Even the accessory battery packs and chargers are calculated fairly, without any hidden costs



SERVICE all-inclusive Now also for accessory battery packs and chargers

FULL SET

Basic device in a SYSTAINER

- + 2 x 5.2 Ah battery packs
- + charger
- + FSK 420 cutting rail

Open, remove, get started. The starter set – perfect for getting started with the Festool system.



CONCENTRATE ON WHAT'S MOST IMPORTANT: YOUR WORK.

Every day we consider how we can make life easier for you. With highly sophisticated tools – and services which are tailored to the demands of your work. You want to and need to avoid downtime, unnecessary expenses and additional costs as much as possible. We understand that, which is why we're doing our bit to help you with our SERVICE all-inclusive. Because we value our customers' success.



Register online up to 30 days after purchase to benefit from all services!

www.festool.com.au/sai

36 Month Warranty

Festool is so confident in the quality of the manufacture of its products that it offers a 36 month limited warranty on tools (including cordless), plus batteries and chargers as well!

*Conditions apply – visit www.festool.com.au for terms and conditions.

Rapid Repair Service

Quick and safe: your power tool is repaired efficiently after its arrival at Festool's after-sales service centre by professional Festool technicians and tested to ensure its electrical safety and fully functional operation.

10 Year Spare Parts Availability

10-year replacement parts guarantee: That's the minimum length of time we will keep every replacement part for your device. And if, against all expectations, it should ever be unavailable, you will receive a new replacement device, free of charge.

Try it risk-free.

Satisfaction guaranteed: the tool you purchased is not what you expected? Simply return it to your dealer within 30 days of purchase for a full refund*.

*Conditions apply – see www.festool.com.au/sai

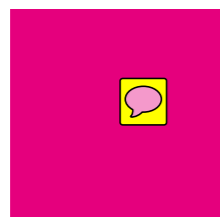

For more information about SERVICE all-inclusive, its validity and our service terms and conditions, please visit www.festool.com.au/sai

SERVICE all-inclusive applies to all machines registered within 30 days of purchase and purchased on or after 2 April 2013.

*The 36 month warranty covers defects in materials and workmanship on the pre-condition that the tool is used and operated in compliance with the Festool operating instructions. For exclusions see www.festool.com.au

Saws for construction at a glance.

The new generation of circular saws



**Cordless circular saw
HKC 55**

HKC 55



Technical specifications

Battery voltage	18 V
Idle engine speed	4,500 rpm ⁻¹
Saw blade diameter	160 mm
Angular range	0–50°
Cutting depth: 0°, 90°	0–55 mm
Cutting depth: 45°/50°	42/38 mm
Dust extractor connection	Ø 27/36 mm
Li-ion battery capacity	5.2 Ah
Weight (with battery pack)	4.1 kg



**Circular saw
HK 55**

HK 55

Technical specifications

Power consumption	1,200 W
Idle engine speed	2,000–5,200 rpm ⁻¹
Saw blade diameter	160 mm
Angular range	0–50°
Cutting depth: 0°, 90°	0–55 mm
Cutting depth: 45°/50°	42/38 mm
Dust extractor connection	Ø 27/36 mm
Weight	4.4 kg



**Circular saw
HK 85**

HK 85

Technical specifications

Power consumption	2,300 W
Idle engine speed	1,500–3,300 rpm ⁻¹
Saw blade diameter	230 mm
Angular range	0–60°
Cutting depth: 0°, 90°	0–85 mm
Cutting depth: 45°/60°	62/47 mm
Dust extractor connection	Ø 27/36 mm
Weight	7.0 kg

Bild folgt
von Festool
Groove
adjuster

Items included

HKC 55 Li 5.2 EB-PLUS-FSK420
2nd Li-ion 5.2 Ah battery pack, TCL 3 charger, HW standard saw blade W18, accessory tool set, FSK 420 cutting rail, in a SYS 4 T-LOC SYSTAINER

Order no. **564627**

HKC 55 Li 5.2 EB-PLUS-FS

2nd Li-ion 5.2 Ah battery pack, TCL 3 charger, HW standard saw blade W18, accessory tool set, FS 1400/2 guide rail, in a SYS 4 T-LOC SYSTAINER

Order no. **N/A**

HKC 55 Li 5.2 EB-PLUS

2nd Li-ion 5.2 Ah battery pack, TCL 3 charger, HW standard saw blade W18, accessory tool set, in a SYS 4 T-LOC SYSTAINER

Order no. **767691**

HKC 55 EB Li-BASIC

HW standard saw blade W18, accessory tool set, in a SYS 4 T-LOC SYSTAINER

Order no. **564636**

Items included

HK 55 EBQ-PLUS-FSK420
HW standard saw blade W18, accessory tool set, FSK 420 cutting rail, in a SYS 4 T-LOC SYSTAINER

Order no. **574679**

HK 55 EBQ-PLUS-FS

HW standard saw blade W18, accessory tool set, FS 1400/2 guide rail, in a SYS 4 T-LOC SYSTAINER

Order no. **574674**

HK 55 EBQ-PLUS

HW standard saw blade W18, accessory tool set, in a SYS 4 T-LOC SYSTAINER

Order no. **561732**

Items included

HK 85 EB-PLUS-FSK420
HW standard saw blade W24, parallel side fence, accessory tool set, FSK 420 cutting rail, in a SYS 5 T-LOC SYSTAINER

Order no. **574666**

HK 85 EB-PLUS-FS

HW standard saw blade W24, parallel side fence, accessory tool set, FS 1400/2 guide rail, in a SYS 5 T-LOC SYSTAINER

Order no. **574662**

HK 85 EB-PLUS

HW standard saw blade W24, parallel side fence, accessory tool set, in a SYS 5 T-LOC SYSTAINER

Order no. **767695**

HK 85 EB

HW standard saw blade W24, parallel side fence, accessory tool set, in carton

Not available

Accessories

Technical specifications Cutting rails	FSK 250	FSK 420	FSK 670
Cutting length (at 50 mm material thickness)	250 mm	420 mm	670 mm
Angle cuts	-45° to +60°	-60° to +60°	-60° to +60°
Weight	0.97 kg	1.25 kg	1.64 kg

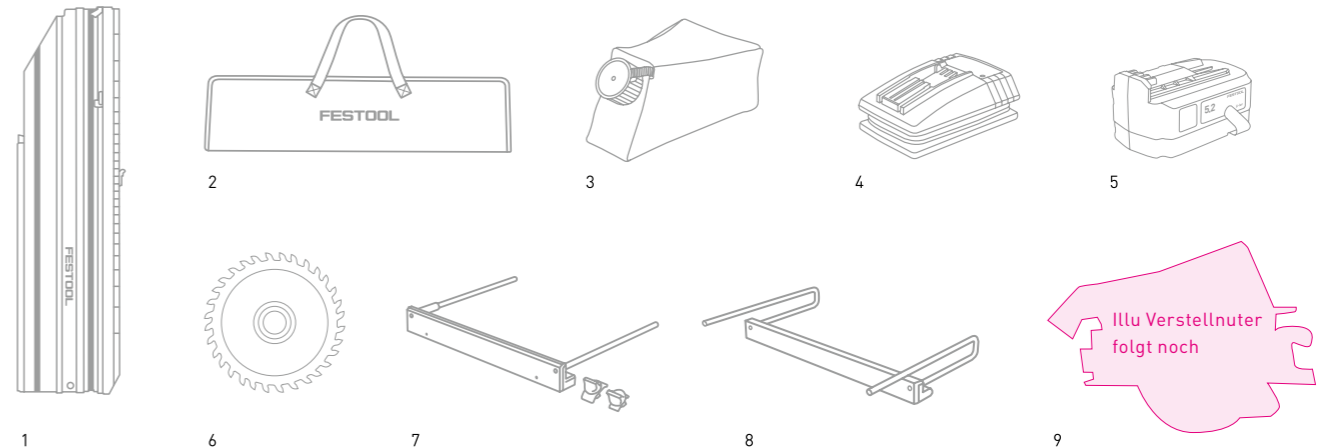

Ille Verstellnuter
folgt noch

Items included Accessories

	Order no.
1 Cutting rails	
FSK 250	769941
FSK 420	769942
FSK 670	769943
2 FSK 420-BAG bag	200160
Carry bag with shoulder strap for FSK 420 and FSK 250	
FSK 670-BAG bag	200161
Carry bag with shoulder strap for FSK 670	
3 SB-TSC dust collector bag	500393
4 TCL 3 charger	499335
5 BPC 18 5.2 Ah Li-ion battery pack	500435
6 Saw blades for HKC 55 and HK 55	
Standard saw blade 160x1.8x20 W18	500458
For all types of wood, construction panels, soft plastics and coarse cuts	
Fine tooth saw blade 160x1.8x20 W32	500459
For all types of wood, laminated boards, MDF and fine cuts	
Panther saw blade 160x1.8x20 PW12	500460
For fast cutting with less power, especially for longitudinal cuts of solid wood	

Items included Accessories





	Order no.
6 Saw blades for HK 85	
Standard saw blade 230x2.5x30 W24	500647
For all types of wood, construction panels, soft plastics and coarse cuts	
Fine tooth saw blade 230x2.5x30 W48	500648
For clean and splinter-free cross cuts in solid wood	
Panther saw blade 230x2.5x30 W18	500646
For fast cutting with less power, especially for longitudinal cuts of solid wood. Suitable for hardwood and softwood	
Special saw blade 230x2.5x30 TF76	500649
For aluminium boards and profiles as well as for hard and fibre-reinforced plastics	
Flat tooth saw blade 230x2.5x30 F48	500651
Ideal for sawing steel cable ducts, steel sheets and steel profiles as well as sandwich boards with foam or polystyrene core and aluminium/steel sheets	
7 Parallel side fence for HKC 55 and HK 55	
PA-HKC 55	500644
Parallel side fence for HK 85	
PA-HK 85	500645
8 Offset parallel side fence for HK 85	574670
9 VN-HK85 groove adjuster 130 x 16-25	200163
Conversion kit to convert HK 85 into a groove router; routing depth adjustable from 0–35 mm and routing width adjustable from 16–25 mm	

Saws for construction at a glance.

Additional product variants can be found at www.festool.com.au

More hand-guided saws

Semi-stationary sawing

 <p>Cordless pendulum jigsaws CARVEX PSC 420</p>  	 <p>Circular saw TS 55 R</p> <p>TS 55 R</p>	 <p>Carpentry circular saw HK 132 E</p>  <p>HK 132 E</p>	 <p>Sword saw UNIVERS SSU 200</p> <p>UNIVERS</p>	 <p>Sliding compound mitre saw KAPEX KS 120</p> <p>KAPEX</p>	 <p>Trimming saw PRECISIO CS 70</p> <p>PRECISIO</p>																																																																																																										
<ul style="list-style-type: none"> ▶ Extra powerful with lithium-ion batteries ▶ Outstanding curve control with triple saw blade guide and torsion-resistant lifting rod ▶ Easy handling with soft grip and ergonomic design <p>Technical specifications</p> <table border="1"> <tr><td>Battery voltage</td><td>18 V</td></tr> <tr><td>Stroke rate</td><td>1,500–3,800 min⁻¹</td></tr> <tr><td>Pendulum cover adjustment in stages</td><td>4</td></tr> <tr><td>Cutting depth in wood</td><td>120 mm</td></tr> <tr><td>Cutting depth in NF metals</td><td>20 mm</td></tr> <tr><td>Cutting depth in steel (soft)</td><td>10 mm</td></tr> <tr><td>Battery capacity</td><td>5.2 Ah</td></tr> <tr><td>Weight</td><td>2.4 kg</td></tr> </table>	Battery voltage	18 V	Stroke rate	1,500–3,800 min ⁻¹	Pendulum cover adjustment in stages	4	Cutting depth in wood	120 mm	Cutting depth in NF metals	20 mm	Cutting depth in steel (soft)	10 mm	Battery capacity	5.2 Ah	Weight	2.4 kg	<ul style="list-style-type: none"> ▶ Complete versatility due to slimline housing for minimum distance to wall (12 mm) ▶ Angle adjustment with undercut function from -1 to 47° ▶ Guide wedge for safer work and simple positioning in existing joint ▶ Transparent sliding viewing window provides a good view of the scribe mark and saw blade <p>Technical specifications</p> <table border="1"> <tr><td>Power consumption</td><td>1,200 W</td></tr> <tr><td>Idle engine speed</td><td>2,000–5,200 rpm⁻¹</td></tr> <tr><td>Saw blade diameter</td><td>160 mm</td></tr> <tr><td>Angular range</td><td>-1 – 47°</td></tr> <tr><td>Cutting depth</td><td>0–55 mm</td></tr> <tr><td>Cutting depth: 45°</td><td>0–43 mm</td></tr> <tr><td>Dust extractor connection</td><td>Ø 27/36 mm</td></tr> <tr><td>Weight</td><td>4.5 kg</td></tr> </table>	Power consumption	1,200 W	Idle engine speed	2,000–5,200 rpm ⁻¹	Saw blade diameter	160 mm	Angular range	-1 – 47°	Cutting depth	0–55 mm	Cutting depth: 45°	0–43 mm	Dust extractor connection	Ø 27/36 mm	Weight	4.5 kg	<ul style="list-style-type: none"> ▶ Trouble-free sawing even with mitre cutting thanks to the hinged-cover remote control ▶ Precise mitre cutting up to 60° with stable pivot bearings and accurate scale ▶ More comfort with electronics: soft start, consistent speed, overload protection and angulation temperature control ▶ Wide range of uses by simply mounting the bird's mouth or slicer attachment <p>Technical specifications</p> <table border="1"> <tr><td>Power consumption</td><td>2,300 W</td></tr> <tr><td>Idle engine speed</td><td>2,200 min⁻¹</td></tr> <tr><td>Cutting depth at 0°/90°</td><td>50–132 mm</td></tr> <tr><td>Cutting depth at 45°/60°</td><td>85/50 mm</td></tr> <tr><td>Mitre cutting</td><td>0–60°</td></tr> <tr><td>Saw blade dimensions</td><td>350 x 30/3.5 mm</td></tr> <tr><td>Weight</td><td>18 kg</td></tr> </table>	Power consumption	2,300 W	Idle engine speed	2,200 min ⁻¹	Cutting depth at 0°/90°	50–132 mm	Cutting depth at 45°/60°	85/50 mm	Mitre cutting	0–60°	Saw blade dimensions	350 x 30/3.5 mm	Weight	18 kg	<ul style="list-style-type: none"> ▶ Accurate cutting of wood and pressure-resistant insulating materials ▶ Ideal for construction sites: 200 mm cutting depth at a weight of 6.5 kg ▶ Straight and splinter-free cuts thanks to guide rail ▶ Versatile use for mitre cutting angle up to 60° <p>Technical specifications</p> <table border="1"> <tr><td>Power consumption</td><td>1,600 W</td></tr> <tr><td>Idle engine speed</td><td>4,600 min⁻¹</td></tr> <tr><td>Cutting depth at 0°; 90°/45°/60°</td><td>200/140/100 mm</td></tr> <tr><td>Mitre cutting</td><td>0–60°</td></tr> <tr><td>Cutting speed</td><td>10.6 m/s</td></tr> <tr><td>Blade position</td><td>0–10°</td></tr> <tr><td>Mains cable</td><td>7.5 m</td></tr> <tr><td>Weight</td><td>6.5 kg</td></tr> </table>	Power consumption	1,600 W	Idle engine speed	4,600 min ⁻¹	Cutting depth at 0°; 90°/45°/60°	200/140/100 mm	Mitre cutting	0–60°	Cutting speed	10.6 m/s	Blade position	0–10°	Mains cable	7.5 m	Weight	6.5 kg	<ul style="list-style-type: none"> ▶ Dual ball bearing-mounted double column guide for unique precision ▶ A double laser line precisely marks the saw cut ▶ Precision adjustment enables angle of saw blade to be set with millimetre accuracy ▶ Integrated extra mitre position for cutting depth up to max. 120 mm <p>Technical specifications</p> <table border="1"> <tr><td>Power consumption</td><td>1,600 W</td></tr> <tr><td>Idle engine speed</td><td>1,400–3,400 rpm⁻¹</td></tr> <tr><td>Saw blade diameter</td><td>260 mm</td></tr> <tr><td>Cutting depth: 90°/90°</td><td>305 x 88 mm</td></tr> <tr><td>Cutting depth: 45°/90°</td><td>215 x 88 mm</td></tr> <tr><td>Special cutting depth 90°/90°</td><td>60 x 120 mm</td></tr> <tr><td>Crown moulding dia. cut 45°/90°</td><td>168 mm</td></tr> <tr><td>Inclination angle</td><td>47/47°</td></tr> <tr><td>Dimensions (W x D x H)</td><td>713 x 500 x 470 mm</td></tr> <tr><td>Dust extractor connection</td><td>Ø 27/36 mm</td></tr> <tr><td>Weight</td><td>21.5 kg</td></tr> </table>	Power consumption	1,600 W	Idle engine speed	1,400–3,400 rpm ⁻¹	Saw blade diameter	260 mm	Cutting depth: 90°/90°	305 x 88 mm	Cutting depth: 45°/90°	215 x 88 mm	Special cutting depth 90°/90°	60 x 120 mm	Crown moulding dia. cut 45°/90°	168 mm	Inclination angle	47/47°	Dimensions (W x D x H)	713 x 500 x 470 mm	Dust extractor connection	Ø 27/36 mm	Weight	21.5 kg	<ul style="list-style-type: none"> ▶ Powerful motor for top cutting performance, even through harder materials ▶ 70 mm cutting height for even more versatility ▶ Quick conversion from rip cuts to cross cuts with the angle stop ▶ Moving splinter guard for splinter-free cuts on both sides <p>Technical specifications</p> <table border="1"> <tr><td>Power consumption</td><td>2,200 W</td></tr> <tr><td>Idle engine speed</td><td>2,000–4,200 min⁻¹</td></tr> <tr><td>Saw blade diameter</td><td>225 mm</td></tr> <tr><td>Cutting height: 90°/45°</td><td>0–70/0–48 mm</td></tr> <tr><td>Inclination</td><td>0 [–2]° – 45 [+47]°</td></tr> <tr><td>Cutting path</td><td>320 mm</td></tr> <tr><td>Table dimensions</td><td>690 x 500 mm</td></tr> <tr><td>Table height, legs folded away</td><td>375 mm</td></tr> <tr><td>Table height, legs unfolded</td><td>900 mm</td></tr> <tr><td>Dust extractor connection</td><td>Ø 27/36 mm</td></tr> <tr><td>Weight</td><td>34.5 kg</td></tr> </table>	Power consumption	2,200 W	Idle engine speed	2,000–4,200 min ⁻¹	Saw blade diameter	225 mm	Cutting height: 90°/45°	0–70/0–48 mm	Inclination	0 [–2]° – 45 [+47]°	Cutting path	320 mm	Table dimensions	690 x 500 mm	Table height, legs folded away	375 mm	Table height, legs unfolded	900 mm	Dust extractor connection	Ø 27/36 mm	Weight	34.5 kg
Battery voltage	18 V																																																																																																														
Stroke rate	1,500–3,800 min ⁻¹																																																																																																														
Pendulum cover adjustment in stages	4																																																																																																														
Cutting depth in wood	120 mm																																																																																																														
Cutting depth in NF metals	20 mm																																																																																																														
Cutting depth in steel (soft)	10 mm																																																																																																														
Battery capacity	5.2 Ah																																																																																																														
Weight	2.4 kg																																																																																																														
Power consumption	1,200 W																																																																																																														
Idle engine speed	2,000–5,200 rpm ⁻¹																																																																																																														
Saw blade diameter	160 mm																																																																																																														
Angular range	-1 – 47°																																																																																																														
Cutting depth	0–55 mm																																																																																																														
Cutting depth: 45°	0–43 mm																																																																																																														
Dust extractor connection	Ø 27/36 mm																																																																																																														
Weight	4.5 kg																																																																																																														
Power consumption	2,300 W																																																																																																														
Idle engine speed	2,200 min ⁻¹																																																																																																														
Cutting depth at 0°/90°	50–132 mm																																																																																																														
Cutting depth at 45°/60°	85/50 mm																																																																																																														
Mitre cutting	0–60°																																																																																																														
Saw blade dimensions	350 x 30/3.5 mm																																																																																																														
Weight	18 kg																																																																																																														
Power consumption	1,600 W																																																																																																														
Idle engine speed	4,600 min ⁻¹																																																																																																														
Cutting depth at 0°; 90°/45°/60°	200/140/100 mm																																																																																																														
Mitre cutting	0–60°																																																																																																														
Cutting speed	10.6 m/s																																																																																																														
Blade position	0–10°																																																																																																														
Mains cable	7.5 m																																																																																																														
Weight	6.5 kg																																																																																																														
Power consumption	1,600 W																																																																																																														
Idle engine speed	1,400–3,400 rpm ⁻¹																																																																																																														
Saw blade diameter	260 mm																																																																																																														
Cutting depth: 90°/90°	305 x 88 mm																																																																																																														
Cutting depth: 45°/90°	215 x 88 mm																																																																																																														
Special cutting depth 90°/90°	60 x 120 mm																																																																																																														
Crown moulding dia. cut 45°/90°	168 mm																																																																																																														
Inclination angle	47/47°																																																																																																														
Dimensions (W x D x H)	713 x 500 x 470 mm																																																																																																														
Dust extractor connection	Ø 27/36 mm																																																																																																														
Weight	21.5 kg																																																																																																														
Power consumption	2,200 W																																																																																																														
Idle engine speed	2,000–4,200 min ⁻¹																																																																																																														
Saw blade diameter	225 mm																																																																																																														
Cutting height: 90°/45°	0–70/0–48 mm																																																																																																														
Inclination	0 [–2]° – 45 [+47]°																																																																																																														
Cutting path	320 mm																																																																																																														
Table dimensions	690 x 500 mm																																																																																																														
Table height, legs folded away	375 mm																																																																																																														
Table height, legs unfolded	900 mm																																																																																																														
Dust extractor connection	Ø 27/36 mm																																																																																																														
Weight	34.5 kg																																																																																																														
<p>Items included</p> <p>PSC 420 EB-Basic Li 18 2 saw blades, splinter guard, in a SYS 2 T-LOC SYSTAINER (battery pack not included, charger not included)</p> <p>Order no. 561738</p>	<p>Items included</p> <p>TS 55 REBQ-Plus-FS HW fine tooth saw blade W48, guide rail FS 1400/2, splinter guard, viewing window, accessory tool set, in a SYSTAINER SYS 4 T-LOC</p> <p>Order no. 561655</p>	<p>Items included</p> <p>HK 132 E HW standard saw blade W24, parallel side fence and extension table, 10 m connecting sleeve, in carton</p> <p>Not available</p>	<p>Items included</p> <p>SSU 200 EB-Plus-FS Universal chainsaw SC 3/8"-91 U-39E, chain oil 250 ml, 7.5 m mains cable, guide rail FS 800/2, in a SYSTAINER SYS 5 TL</p> <p>Not available</p>	<p>Items included</p> <p>KS 120 EB HW universal saw blade W60, bevel, workpiece clamp, accessory tool set, in carton</p> <p>Order no. 561288</p>	<p>Items included</p> <p>CS 70 EB HW universal saw blade W32, angle stop, workpiece holder, accessory tool set, in carton</p> <p>Order no. 561212</p>																																																																																																										

FESTOOL

Tools for the toughest demands

Festool Australia

Postal address: PO Box 4401
Dandenong South VIC 3164
Australia

Service Hotline: 1300 063 900

Fax: 03 8795 9221

E-mail: customercare@tooltechnic.com.au

Hindin Marquip Ltd.

1012 Great South Road

1061 Penrose – Auckland

Phone +64 9 9131666

E-mail hamish@hml.co.nz



SERVICE all-inclusive: 36-month comprehensive warranty, rapid repair service, 10 year spare parts availability and much more.

For more information, go to www.festool.com.au/sai



Returning old devices, recycling, waste avoidance.
For a clean environment.

For more information, go to www.festool.com.au

www.festool.com.au

Retailer

Festool
Construction
Valid from September 2015

Order no. 65009 AUS/en



4 014549 257524

Vibration levels and emission values can be found in the operating instructions at www.festool.com.au

Subject to changes and errors. All images are non-binding.
Produced for Festool GmbH, 73240 Wendlingen, 09/2015